



# Portman Mansions, Chiltern Street

*Marylebone*

OLIVER BERNARD

LONDON

£1,200 per week



# The Property

PORTMAN MANSIONS, CHILTERN STREET, MARYLEBONE, LONDON, W1U

A spacious lower-ground floor furnished apartment. The property is light and airy with a spacious reception room that opens onto a communal terrace. Modern kitchen with integrated appliances. The principal bedroom has an en suite bathroom, 2 further bedrooms and a second bathroom.

The apartment is located to the rear of the building on Chiltern Street and benefits from a porter. Baker Street station is just 0.1 mile away and Marylebone station is 0.3 miles away. The property is superbly located for the numerous restaurants, shops and cafes in the area.

## THE DETAILS

- Long Let
- Minimum term 12 months
- 3 Bedrooms
- 1 Reception Room
- 2 Bathrooms
- Apartment
- Basement
  - Patio
  - Period
  - Porter
- Furnished



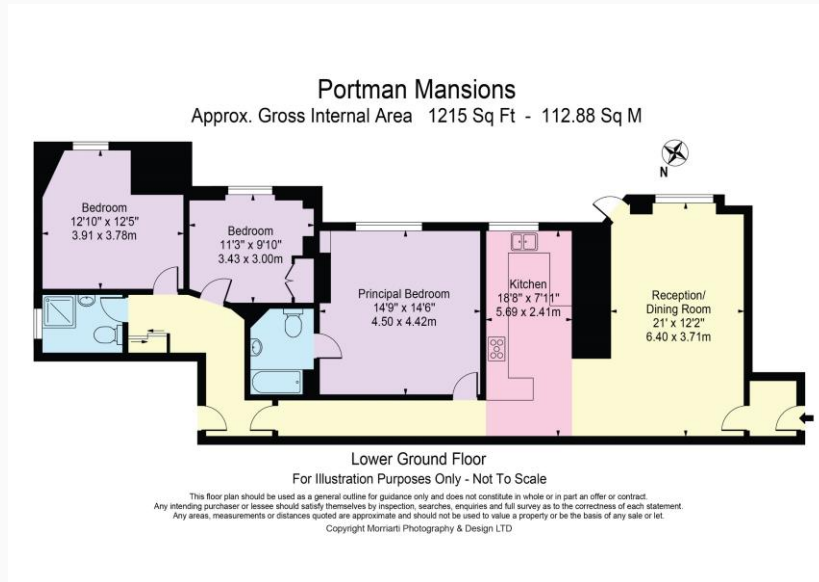

Energy Efficiency Rating		Current	Potential
Very energy efficient - lower running costs			
(92-100)	A		
(81-91)	B		
(69-80)	C		
(55-68)	D	69	77
(39-54)	E		
(21-38)	F		
(1-20)	G		
Not energy efficient - higher running costs			
England, Scotland & Wales		EU Directive 2002/91/EC	

ⓘ

Not to scale, for guidance only and must not be relied upon as a statement of fact. All measurements and areas are approximate only and have been prepared in accordance with the current edition of the RICS Code of Measuring Practice.

**Important Information**

Our property particulars do not represent an offer or contract, or part of one. The information given is without responsibility on the part of the agents, seller(s) or lessor(s) and you should not rely on the information as being factually accurate about the property, its condition or its value. Neither OB Private nor any-one in its employment or acting on its behalf has authority to make any representation or warranty in relation to this property. We have not carried out a detailed survey, nor tested the services, appliances or fittings at the property. The images shown may only represent part of the property and are as they appeared at the time of being photographed. The areas, measurements and distances are approximate only. Any reference to alterations or use does not mean that any necessary planning permission, building regulation or other consent has been obtained. The VAT position relating to the property may change without notice.





# Contact

CHRISTIAN MARKS

MAYFAIR

33 BRUTON STREET  
LONDON  
W1J 6QU

INFO@OBPRIVATE.CO.UK  
0207 118 0747

[www.obprivate.co.uk](http://www.obprivate.co.uk)

